

BD CONNECTOR 3.5mm (.138")

Disconnectable Crimp style connectors

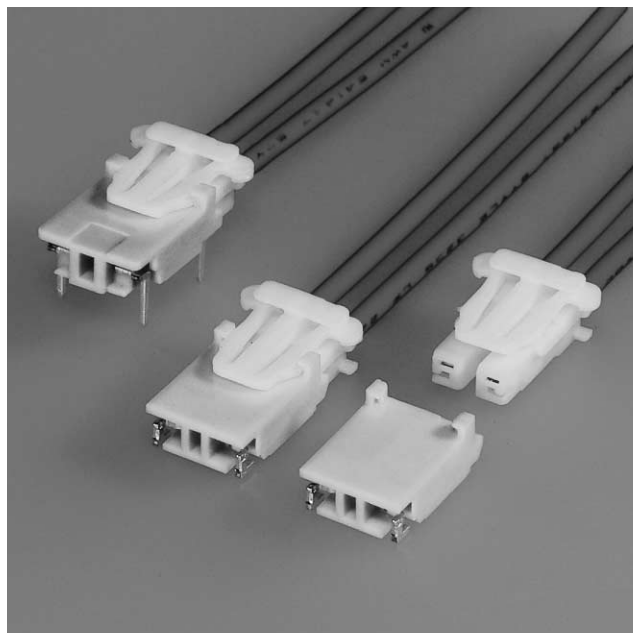

Board-to-wire connector with high withstanding voltage, used for power supply of LCD (Liquid Crystal Display) back light.

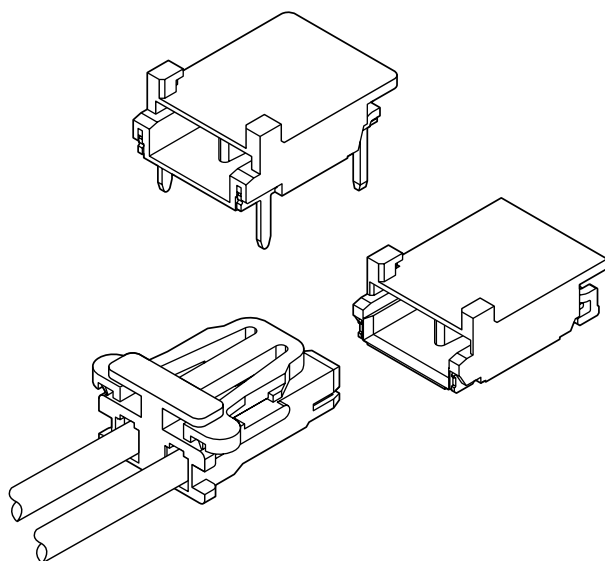

Features

• Secure locking mechanism

Arm-locking mechanism as secure lock is adopted in order to prevent coming out housing.

• High withstand voltage design

Securing the sufficient creepage distance, it considers as high withstanding voltage design. (Conformed to IEC-60950)
When applying voltage rating, consideration of PC board pattern design is required.

• Low profile

Corresponding to thinner LCD, the connector height is designed as small and low profile.

• Compatibility

This BD connector is compatible BHS connector. Secure locking mechanism is available for BD connector header and socket only. Socket contact is same contact as BHS connector.

Specifications

- Current rating: 1.0A AC, DC (AWG #24)
- Voltage rating: 1,400V AC, DC
- Temperature range: -25°C to +85°C
(including temperature rise in applying electrical current)
- Contact resistance: Initial value/10m Ω max.
After environmental testing/20m Ω max.
- Insulation resistance: 1,000M Ω min.
- Withstanding voltage: 3,800V AC/minute (50 to 60 Hz)
- Applicable wire: AWG #28 to #24
- * Contact JST if Lead-Free product is required.
- * Refer to "General Instruction and Notice when using Terminals and Connectors" at the end of this catalog.
- * Contact JST for details.

Standards

Recognized E60389

BD CONNECTOR 3.5mm (.138")

Contact

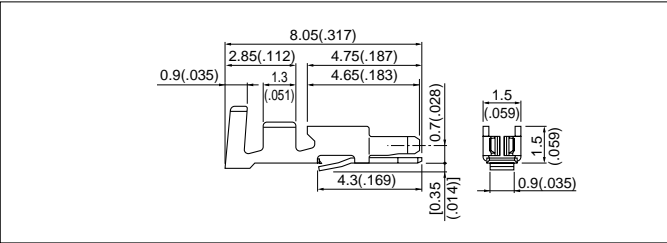

Model No.	Applicable wire		Insulation O.D. mm(in.)	Q'ty / reel
	mm ²	AWG#		
SBHS-002T-P0.5A	0.08 to 0.22	28 to 24	0.9 to 1.7(.035 to .067)	10,000
Material and Finish				
Phosphor bronze, tin-plated				

Note: Contact JST for SBHS-002T-P0.5.

Housing

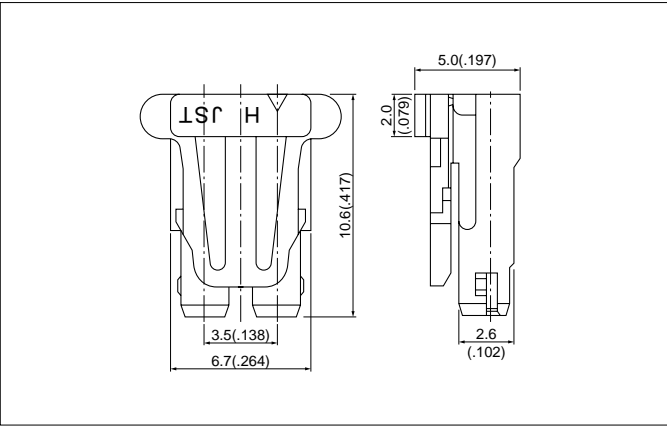

Circuits	Model No.	Q'ty / bag
2	BDMR-02VS-1	1,000
Material		
Nylon 66, UL94V-0, natural (white)		

Header

Through-hole type

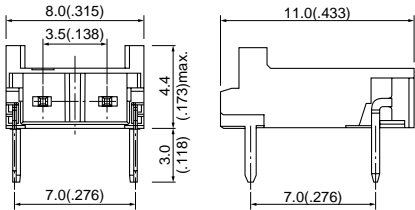

Circuits	Model No.	Q'ty / box
2	S02-BDS-3-TB	1,000
Material and Finish		
Press pin: Brass, Copper-undercoated, tin-plated Wafer: Heat resisting resin, UL94V-0, natural (ivory) Solder tab: Brass, Copper-undercoated, tin-plated		

SMT type

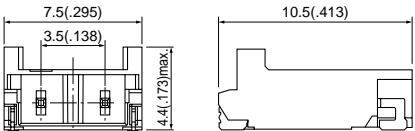

Circuits	Model No.	Q'ty / reel
2	SM02-BDS-3-TB	1,000
Material and Finish		
Post: Brass, nickel-undercoated, tin/copper alloy-plated Wafer: Heat resisting resin, UL94V-0, natural (ivory) Solder tab: Brass, nickel-undercoated, tin/copper alloy-plated		

Note: The product listed above is supplied on embossed tape.

BD CONNECTOR 3.5mm (.138")

Taping specifications

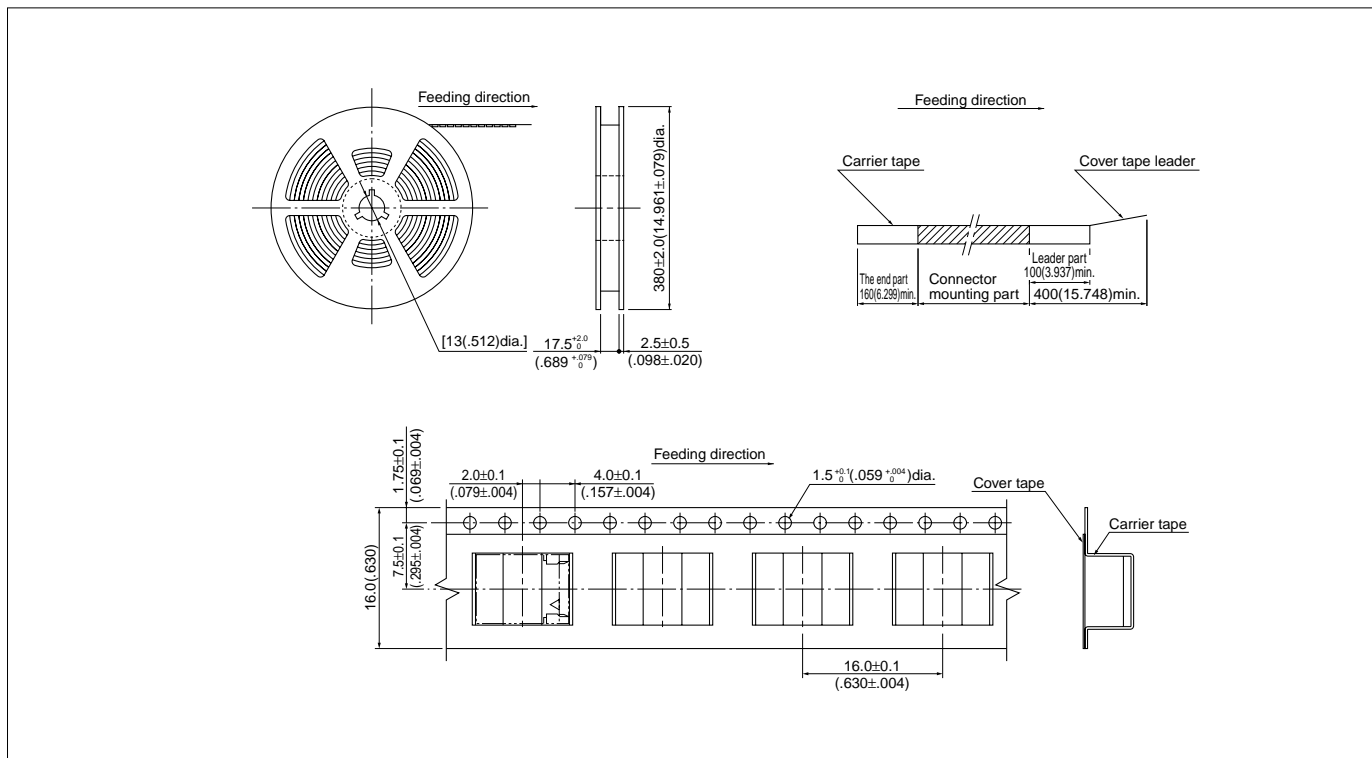

Note:

- Specifications conform to JIS C 0806. The tape width, connector loading recess square hole dimensions, etc. are determined by the number of circuits and external shape of the connector to be loaded.
- Specifications are subject to change without prior notice.

PC board layout (viewed from component side) and Assembly layout

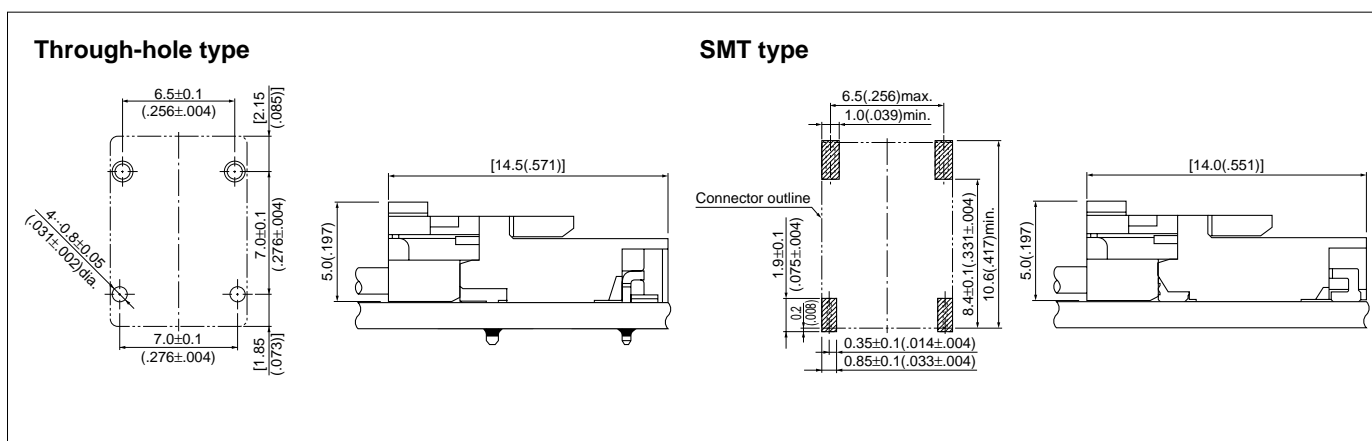

BD CONNECTOR 3.5mm (.138")

Applicator for the semi-automatic press AP-K2N _____

Contact	Crimp applicator MKS-L		Compact crimp applicator MKS-LS		Strip-crimp applicator MKS-SC
	with safety cover	without safety cover	with safety cover	without safety cover	with safety cover
SBHS-002T-P0.5A	APLMK SBHS002-05	APLNC SBHS002-05	—	—	—